

Kidde ECS Fire Suppression System Component Description



Effective: June 2014

K-90-2100 Rev BA

Valve Outlet Adapters

FEATURES

- For Use with UL Listed, ULC Listed and FM Approved Systems
- RoHS Compliant

P/N: WK-28390X-000

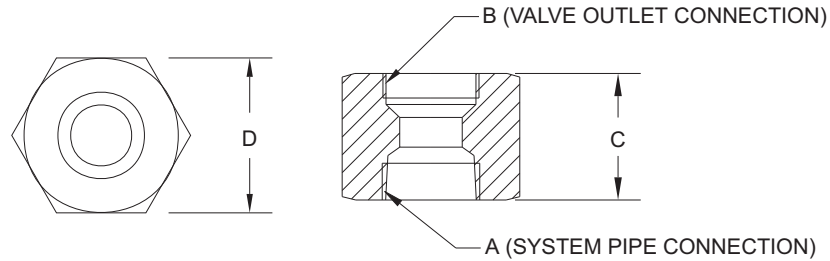

Note: For direct connection of cylinder valve to distribution piping.

MATERIAL

- Brass

ORDERING INFORMATION

Part Number	Size	Dimensions (in inches)			
		A	B	C	D
WK-283904-000	1 1/2	1-1/2 11-1/2 NPT	1.874 12 UNJ	2.69	2.50 HEX
WK-283905-000	2	2 11-1/2 NPT	2.500 12 UNJ	3.12	3.00 HEX
WK-283906-000	2 1/2	2-1/2 8 NPT	3.00 12 UNJ	3.00	3.75 HEX

COMPATIBILITY

Series	For Use With
Kidde ECS HFC-227ea	X
Kidde ECS Advanced Delivery FM-200®	X

This literature is provided for informational purposes only. KIDDE-FENWAL, INC. assumes no responsibility for the product's suitability for a particular application. The product must be properly applied to work correctly. If you need more information on this product, or if you have a particular problem or question, contact KIDDE-FENWAL, Inc.

FM-200 is a registered trademark of E.I. du Pont de Nemours and Company. Kidde is a registered trademark of Kidde-Fenwal Inc. All other trademarks are the property of their respective owners.